

Keystone Jack, Category 6_A, RJ45/s

P/N: KEJ-C6A-S-10G

10
Gigabit

Cat. 6_A
interoperable

500
MHz

PoE
type 4

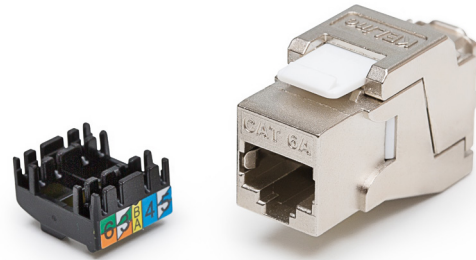

Features

- tool-free, fast and easy installation
- PoE Type 4 (100 W) certified in FORCE Technology laboratories
- enables transmission of all high-speed protocols including 10GBASE-T
- guarantees a bandwidth of 500 MHz
- perfectly shielded against Alien Crosstalk and electromagnetic interference
- suitable for a wide range of outlets, duct and channel systems
- applicable on cables with solid as well as stranded wires

Application

- primary (Campus), secondary (Riser), tertiary (Horizontal)
- IEEE 802.3: 10Base-T; 100Base-T; 1000Base-T; 10GBase-T
- IEEE 802.5 16 MB; ISDN; FDDI; ATM
- high bandwidth digital applications with low BER
- multimedia transmissions like digital and analog video and voice

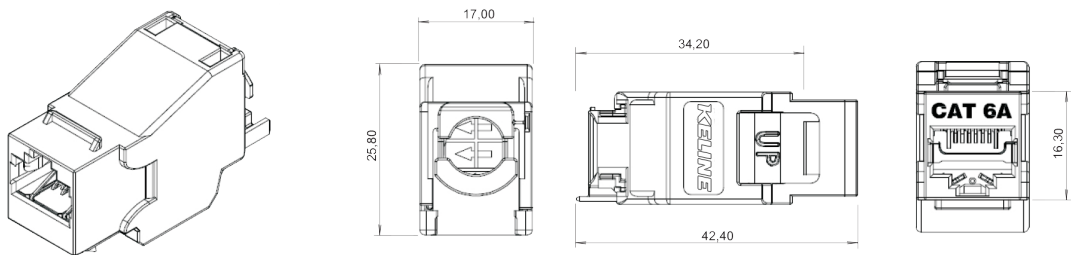

Mechanical properties

Suitable for installing on	cables with solid wires	from 0,51 to 0,64 mm (AWG 24 - AWG 22)
	cables with stranded wires	from AWG 26/7 to AWG 24/7
Required installation depth	for 15 - 40 mm - sockets with angled faceplates	
	for 40 mm - sockets with straight faceplates	
Insertion / extraction cycles	min. 750	
Temperature range	operation	-40°C to +70°C
	installation	-10°C to +60°C
IDC reterminations	min. 20	
Contact pin material	phosphor-bronze alloy coated with 50 μ of gold	
IDC contacts material	high strength phosphor-bronze alloy	
IDC contacts plating	100 micron tin alloy	

Electrical properties at 20°C

Current rating	1,5 A max
Contact resistance of spring	20 m Ω max
Contact resistance of IDC	2,5 m Ω max
Dielectric strenght	1000Vac/ 1 minúta C voči C
	1500Vac/ 1 minúta C voči Panelu
Insulation resistance	500 M Ω min @ 100Vdc

Transmission properties at 20°C

f (MHz)	Attenuation (dB/100m)	NEXT (dB min)	PS-NEXT (dB min)	FEXT (dB min)	Return loss (dB)	TLC (dB min)	PS-ANEXT (dB min)	PS-AFEXT (dB min)
1,0	0,1	75,0	72,0	75,0	30,0	40,0	72,0	72,0
4,0	0,1	75,0	72,0	71,1	30,0	40,0	72,0	72,0
10,0	0,1	74,0	70,0	63,1	30,0	40,0	72,0	72,0
16,0	0,1	69,9	65,9	59,0	30,0	40,0	72,0	72,0
20,0	0,1	68,0	64,0	57,1	30,0	40,0	72,0	72,0
31,2	0,1	64,1	60,1	53,2	30,0	38,1	72,0	72,0
62,5	0,16	58,1	54,1	47,2	30,0	32,1	72,0	71,1
100,0	0,2	54,0	50,0	43,1	28,0	28,0	70,5	67,0
155,5	0,24	50,2	46,2	39,3	25,0	25,0	66,7	63,2
200,0	0,28	48,0	44,0	37,1	22,0	22,0	64,5	61,0
250,0	0,32	46,0	42,0	35,1	20,0	20,0	62,5	59,0
300,0	0,35	43,7	39,7	33,6	18,5	18,5	61,0	57,5
400,0	0,4	39,9	35,9	31,1	16,0	16,0	58,5	55,0
500,0	0,45	37,0	33,0	29,1	14,0	14,0	56,5	53,0



This product is certified on a component level by FORCE Technology international independent laboratories according to ISO/IEC 11801-1:2017 (Ed. 1.0) / ISO/IEC 11801-2:2017 (Ed. 1.0), IEC 60603-7-51:2010, EN 50173-1:2018 / EN 50173-2:2018, TIA-568.2-D:2018, IEC 60512-99-002:2022.

Mass production of this product is carried out under the supervision of FORCE Technology EC Verified Maintenance of Certification Schedule Quality Audit of the Manufacturer's Production and Quality Assurance Sites.