

COPYRIGHT © Hangzhou EZVIZ Software Co., Ltd. ALL RIGHTS RESERVED.

Any and all information, including, among others, wordings, pictures, graphs are the properties of Hangzhou EZVIZ Software Co., Ltd. (hereinafter referred to as “EZVIZ”). This user manual (hereinafter referred to as “the Manual”) cannot be reproduced, changed, translated, or distributed, partially or wholly, by any means, without the prior written permission of EZVIZ. Unless otherwise stipulated, EZVIZ does not make any warranties, guarantees or representations, express or implied, regarding to the Manual.

About this Manual

The Manual includes instructions for using and managing the product. Pictures, charts, images and all other information hereinafter are for description and explanation only. The information contained in the Manual is subject to change, without notice, due to firmware updates or other reasons. Please find the latest version in the EZVIZ™ website (<http://www.ezviz.com>).

Revision Record

New release – January, 2022

Trademarks Acknowledgement

ezviz™, ™, and other EZVIZ's trademarks and logos are the properties of EZVIZ in various jurisdictions. Other trademarks and logos mentioned below are the properties of their respective owners.

Legal Disclaimer

TO THE MAXIMUM EXTENT PERMITTED BY APPLICABLE LAW, THE PRODUCT DESCRIBED, WITH ITS HARDWARE, SOFTWARE AND FIRMWARE, IS PROVIDED “AS IS”, WITH ALL FAULTS AND ERRORS, AND EZVIZ MAKES NO WARRANTIES, EXPRESS OR IMPLIED, INCLUDING WITHOUT LIMITATION, MERCHANTABILITY, SATISFACTORY QUALITY, FITNESS FOR A PARTICULAR PURPOSE, AND NON-INFRINGEMENT OF THIRD PARTY. IN NO EVENT WILL EZVIZ, ITS DIRECTORS, OFFICERS, EMPLOYEES, OR AGENTS BE LIABLE TO YOU FOR ANY SPECIAL, CONSEQUENTIAL, INCIDENTAL, OR INDIRECT DAMAGES, INCLUDING, AMONG OTHERS, DAMAGES FOR LOSS OF BUSINESS PROFITS, BUSINESS INTERRUPTION, OR LOSS OF DATA OR DOCUMENTATION, IN CONNECTION WITH THE USE OF THIS PRODUCT, EVEN IF EZVIZ HAS BEEN ADVISED OF THE POSSIBILITY OF SUCH DAMAGES.

TO THE MAXIMUM EXTENT PERMITTED BY APPLICABLE LAW, IN NO EVENT SHALL EZVIZ'S TOTAL LIABILITY FOR ALL DAMAGES EXCEED THE ORIGINAL PURCHASE PRICE OF THE PRODUCT.

EZVIZ DOES NOT UNDERTAKE ANY LIABILITY FOR PERSONAL INJURY OR PROPERTY DAMAGE AS THE RESULT OF PRODUCT INTERRUPTION OR SERVICE TERMINATION CAUSED BY: A) IMPROPER INSTALLATION OR USAGE OTHER THAN AS REQUESTED; B) THE PROTECTION OF NATIONAL OR PUBLIC INTERESTS; C) FORCE MAJEURE; D) YOURSELF OR THE THIRD PARTY, INCLUDING WITHOUT LIMITATION, USING ANY THIRD PARTY'S PRODUCTS, SOFTWARE, APPLICATIONS, AND AMONG OTHERS.

REGARDING TO THE PRODUCT WITH INTERNET ACCESS, THE USE OF PRODUCT SHALL BE WHOLLY AT YOUR OWN RISKS. EZVIZ SHALL NOT TAKE ANY RESPONSIBILITIES FOR ABNORMAL OPERATION, PRIVACY LEAKAGE OR OTHER DAMAGES RESULTING FROM CYBER ATTACK, HACKER ATTACK, VIRUS INSPECTION, OR OTHER INTERNET SECURITY RISKS; HOWEVER, EZVIZ WILL PROVIDE TIMELY TECHNICAL SUPPORT IF REQUIRED. SURVEILLANCE LAWS AND DATA PROTECTION LAWS VARY BY JURISDICTION. PLEASE CHECK ALL RELEVANT LAWS IN YOUR JURISDICTION BEFORE USING THIS PRODUCT IN ORDER TO ENSURE THAT YOUR USE CONFORMS TO THE APPLICABLE LAW. EZVIZ SHALL NOT BE LIABLE IN THE EVENT THAT THIS PRODUCT IS USED WITH ILLEGITIMATE PURPOSES.

IN THE EVENT OF ANY CONFLICTS BETWEEN THE ABOVE AND THE APPLICABLE LAW, THE LATTER PREVAILS.

Table of Contents

Overview	1
1. Package Contents.....	1
2. Basics.....	2
Quick Use Guide	4
1. Install the Handle.....	4
2. Charge.....	4
3. Change Language	5
4. Add Clean Water	5
5. Start Cleaning.....	5
6. Switch Mode.....	6
7. Self-cleaning	6
8. Pour Dirty Water	7
9. Rolling Brush Air Dry Introduction	7
Product Disassembly.....	7
1. Disassembly of Handle	7
2. Handling Method For Waste Battery.....	8
Routine Maintenance.....	9
1. Product Maintenance-clean the Main Device Body.....	9
2. Cleaning Dirt Degree Sensor	9
3. Cleaning Top Cover of the Dirty Water Bucket/ Floater/ Dirt Separator	9
4. Cleaning the HEPA.....	10
5. Cleaning the Rolling Brush.....	10
FAQ	12

Overview

1. Package Contents



Main Device Body (x1)



Handle (x1)



Charging Base (x1)



Power Adapter (x1)



High Efficiency Particulate Air Filter (HEPA) (x1)



Rolling Brush (x1)



Cleaning Brush (x1)



HEPA Rack (x1)



Cleaning Brush/ Rolling Brush Rack (x1)



Cleaning Solution(x1)



Quick Start Guide (x1)



User Manual (x1)

2. Basics

Vacuum Cleaner

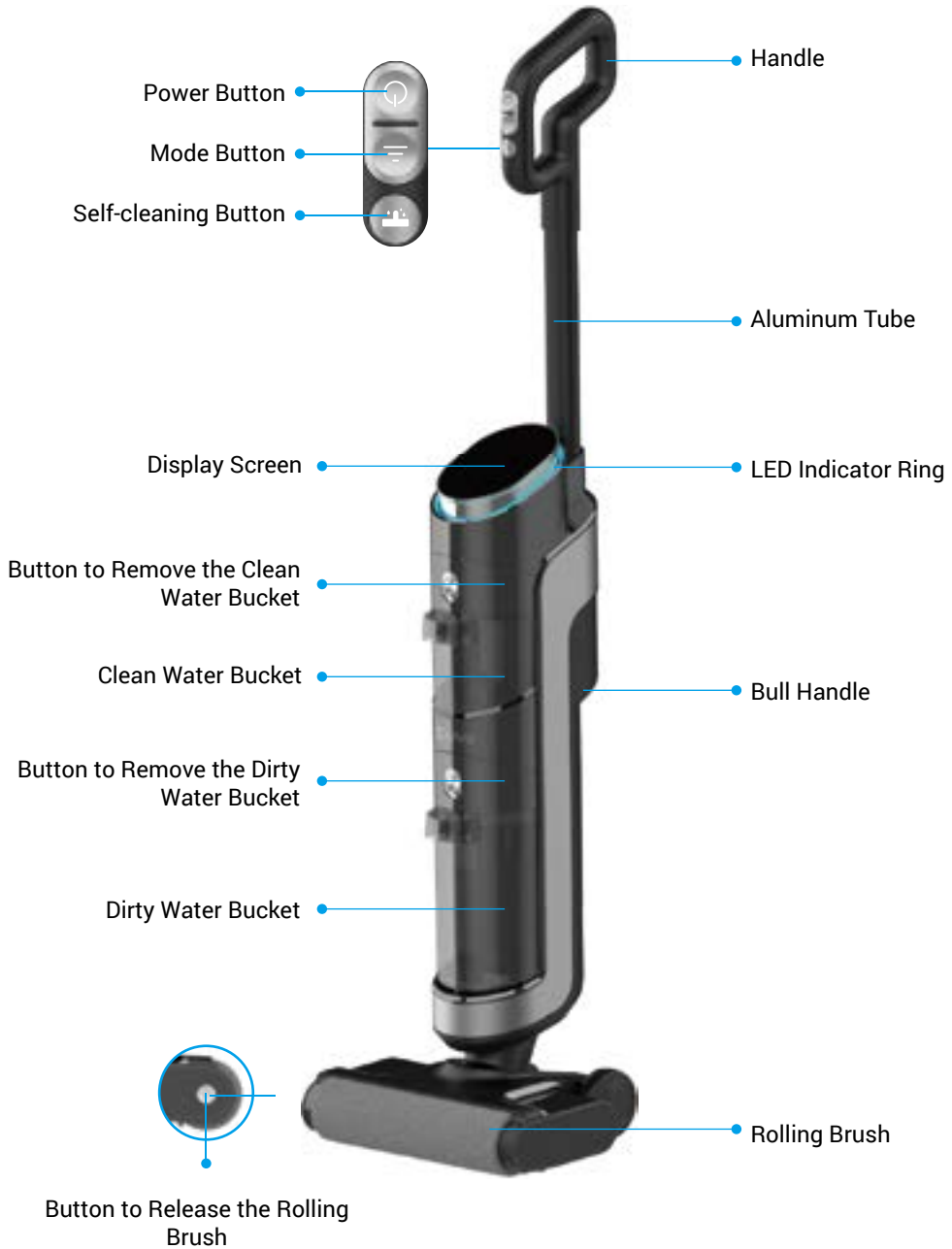

Name	Description
Power Button	<ul style="list-style-type: none"> Press and hold for 3 seconds to power on. Press once to power off.
Mode Button	<ul style="list-style-type: none"> When cleaning, press Mode Button to switch between Auto Mode/ Standard Mode/ Power Mode. When charging, press Mode Button to turn on/ off rolling brush air dry clean mode. When charging, press and hold Mode Button for 3 seconds to enter language changing mode. Press once to change to a different language. Press and hold Mode Button for 3 seconds to exit.
Self-cleaning Button	<ul style="list-style-type: none"> When charging, press Self-cleaning Button to turn on/off Self-cleaning Mode. The whole progress would take 2 minutes. It is highly recommended to clean dirty water bucket after self-cleaning is finished. Press and hold Self-cleaning Button for 3 seconds to turn on/off the voice mode.

Name	Description
LED Indicator Ring	Cleanness of the floor : <ul style="list-style-type: none"> • Purple: very dirty • Yellow: a little dirty • Blue: normal • Red: dirt degree sensor may be covered by the dirt

Charging Base

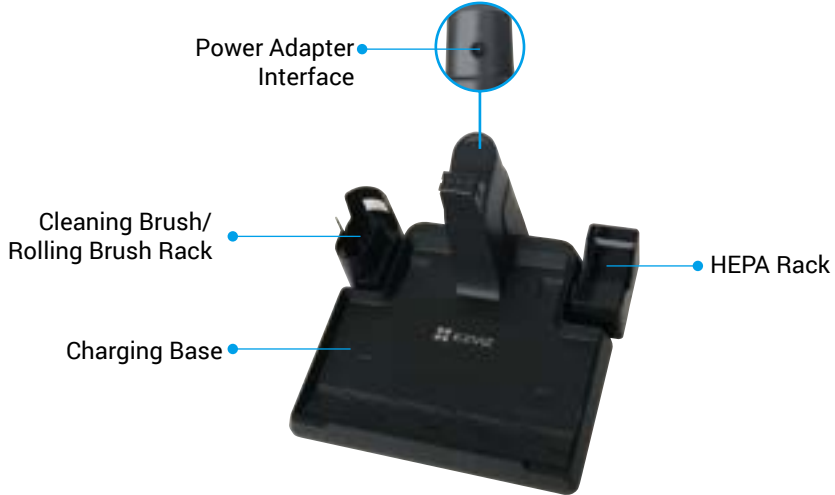

Display Screen

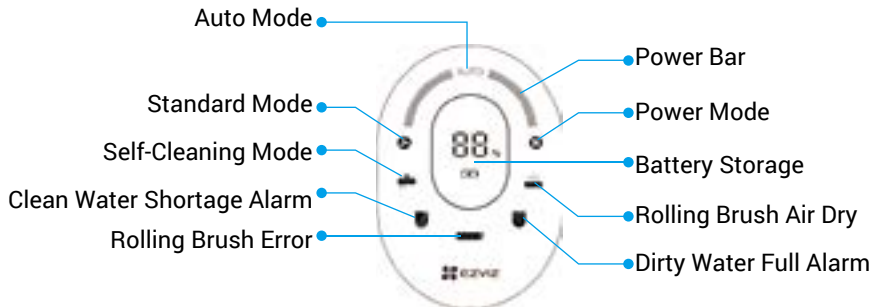

Quick Use Guide

1. Install the Handle

Insert the end of the handle vertically into the port of the device till you hear 'click' sound. Make sure the handle is tight and firm so that the installation can be successful.



2. Charge

Before using, please connect the interface and charging base with the power adaptor, and then put the device on the charging base for charging. Make sure that the device is fully charged before being used.

- Put away the charging base when not charging.
- When charging, keep the device upright and in the corner to avoid a falling down or other problems.
- A full charge takes approximately 4 ± 0.5 hours.
- The display screen will show the battery storage and there will be voice prompt when the device is fully charged.



3. Change Language

When device charging, press and hold the Mode Button for 3 seconds to enter language changing mode (Language order: English, French, German, Italian). Please press Mode Button to change to a different language and press and hold the Mode Button for 3 seconds to exit. The default language is English.

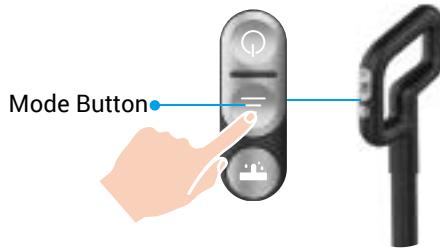

4. Add Clean Water

Take off the clean water bucket and open the bucket cover, and then add clean water and half a bottle cap of cleaning solution (about 3.5ml), and close the bucket cover and then install the bucket back to the device.

- ⓘ The water temperature should be lower than 60°C (140°F).



1. Take off the clean water bucket and fill it up with clean water and half a bottle cap of cleaning solution (about 3.5ml).



2. Install the bucket back to the device, you can hear 'click' sound. Make sure the cover is tight.

5. Start Cleaning

Take the device off from the charging base and gently step on the brush heads after placing it on the ground, and then tilt the device backward; press the Power Button for about 3s to start the device.

The default working mode is Auto Mode. Press the Power Button to stop working.

- ⓘ Please do not clean alcohol, foam liquid and etc. with the device.

WARNING:

- Do not use on foam liquid. Power Mode is recommended to be used in heavily soiled environments.
- This appliance comes with a vertical switch. When working, please lean it before you use it. The tilt angle cannot exceed 140 degrees in case of water leaking.

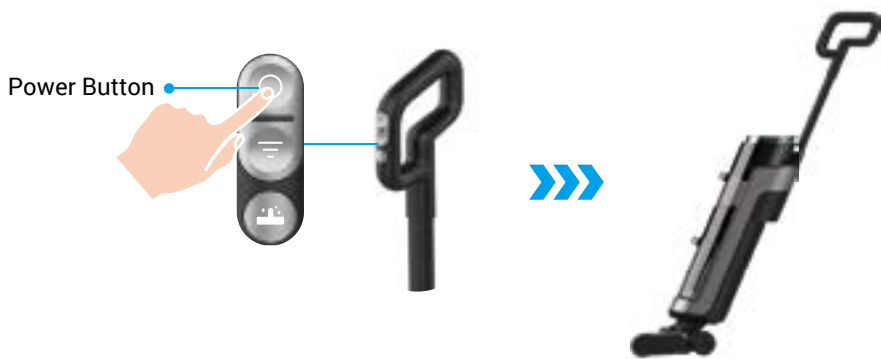

6. Switch Mode

When working, press Mode Button to switch to Standard or Power Mode. Press Power Button to finish your cleaning.

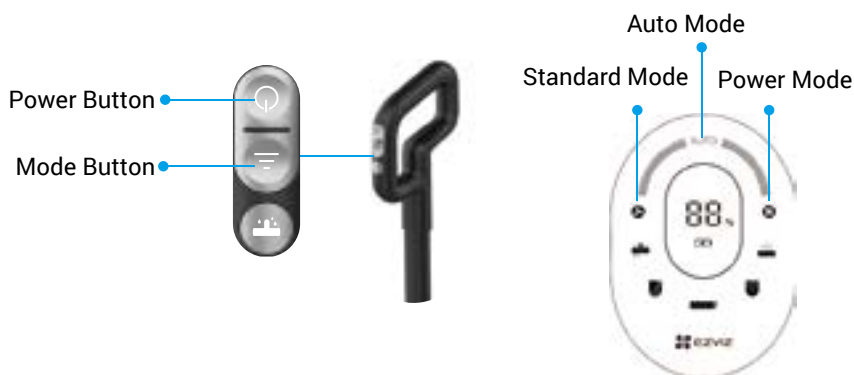

7. Self-cleaning

- Please replace the dirty water in the dirty water bucket before the self-cleaning is performed or after the self-cleaning is finished; if there is any remaining dirty marks on the charging base, please clean it in time.
- Press and hold the Self-cleaning Button for over 3s to enable/disable voice function.
- Please pay attention to the base cleaning after Self-cleaning of the rolling brush is performed.
- Please put the device back into the charging base in time after use, you can enable the self-cleaning function according to the dirty degree of the rolling brush.
- When you need to clean your device, press the Self-cleaning Button on the back of the handle to start self-cleaning.
- After self-cleaning is finished, the device enters into charging status.

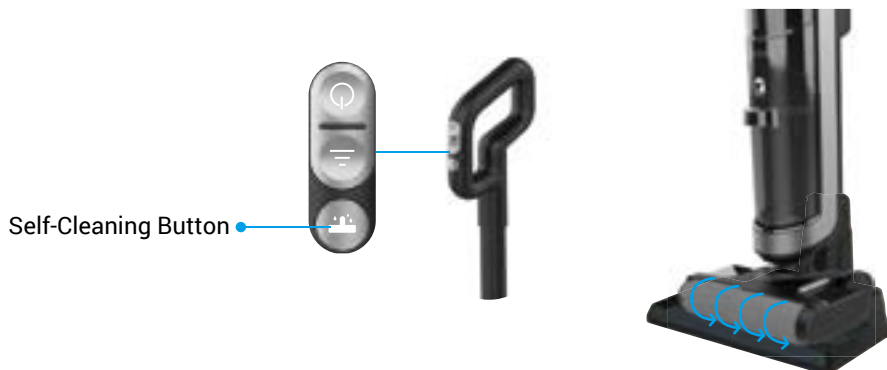

8. Pour Dirty Water

Take off the dirty water bucket and open the bucket cover to take out of the dirt separator within the bucket, and then pour down the dirty water and clean the dirty marks, and finally install the dirty bucket back into the device.

- If HEPA is required to be washed, please install and use it after wash and dry it, otherwise the device performance will be affected.
- Always hold the bucket. If you hold the cover, the bucket body may drop.



1. Take out dirty water bucket.



2. Hold the bucket and take out the cover.



3. Take out the dirt separator.



4. Clean the cover, the dirt separator and the bucket.



5. Put them back and install the bucket back to the device, you can hear 'click' sound.

9. Rolling Brush Air Dry Introduction

- When charging, rolling brush air dry mode is automatically on.
- To make sure the rolling brush is air-dried more evenly and thoroughly, the rolling brush rolls every 3 minutes during this progress.
- This mode will run continuously for about 2 hours.

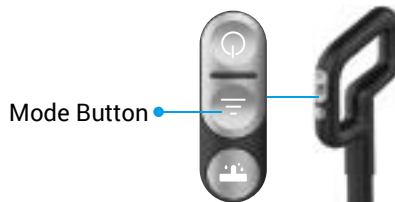

Product Disassembly

1. Disassembly of Handle

- Use tools, such as tweezers, to strip the soft robber on the back of the device.
- Find another slender tool, such as a hex screwdriver, to press it into the hole, and pull the handle up in the meantime.



2. Handling Method For Waste Battery

- The battery installed in the device contains harmful substances to the environment. Before abandoning the device, you must take out the battery from the device; when taking out the battery, you must power off the device.
- Please handle the waste batteries properly and safely, do not put the waste batteries into fire, water or soil.
- When your skin or clothing touches the leaked liquid of the waste battery, please wash with clean water to avoid a skin irritation, and then go to hospital for treatment rapidly.



1. Take out dirty water bucket.



2. Take out decorative pieces with tweezers.



3. Loosen two screws under the cover with plus driver (no need to take out these two screws).



4. Take out two screws on the back of the device with plus driver.

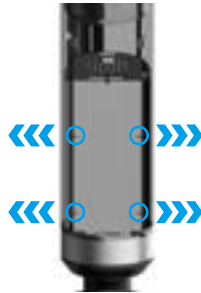

5. Take out these four screws with plus driver.



6. Open the back cover very hard with tweezers.

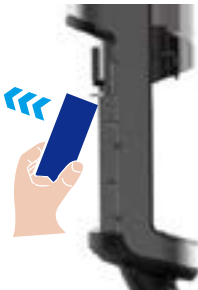

7. Put on rubber gloves and take out the battery.

Routine Maintenance

In order not to affect the device performance, it is recommended to maintain the components regularly.

1. Product Maintenance-clean the Main Device Body

- a. Before cleaning, please let the device stop to work.
- b. Wipe and wash with water or neutral detergent, and be sure that wring out the cleaning cloth before wiping the device. (Please prevent water from entering the interior of the device electrical elements.)



2. Cleaning Dirt Degree Sensor

- a. The dirt degree sensor may be covered by the dirt when there is no obvious dirt on the ground and the LED indicator ring is full-red or flashes in full-red.
- b. Before using, please take off the dirty water bucket and wipe the dirt degree sensor in channel with wet rag or clean the dirt within the channel with provided cleaning tools.



3. Cleaning Top Cover of the Dirty Water Bucket/ Floater/ Dirt Separator

- The device will stop working automatically and remind you through display screen and voice prompt when dirty water bucket is full.
- Please clean the dirty mark directly with small cleaning tool when you find any stubborn dirty marks on inner wall of the dirty water bucket.
- Always hold the bucket. If you hold the cover, the bucket body may drop.
- After cleaning is finished, please close the dirty water bucket cover and install it back to device body. The installation is successful when you hear 'click' sound.



1. Take out dirty water bucket.



2. Hold the bucket and take out the cover.



3. Take out the dirt separator.



4. Clean the cover, the dirt separator and the bucket.



5. Put them back and install the bucket back to the device, you can hear 'click' sound.

4. Cleaning the HEPA



1. Take HEPA out from the top of the dirty water bucket.

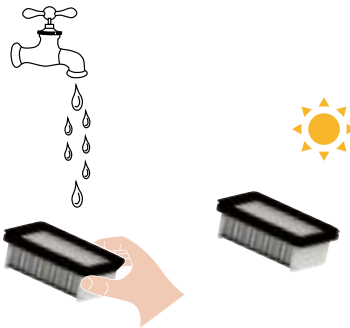

2. Clean HEPA with clean water and then dry it.



3. Dry the HEPA thoroughly and then install it back into the dirty water bucket.

- Dry the HEPA thoroughly and then install it back into the dirty water bucket, otherwise the device performance will be affected.
- It is recommended to replace a new HEPA once every 2~3 months.

5. Cleaning the Rolling Brush

If you want to clean the residual stains on the suction nozzle, please clean it with wet rag. Rinsing it with water is forbidden.



1. Press the button on the left side of device and take out the rolling brush.



2. You can remove the hairs or chippings rapped on the brush heads with cleaning brush.



3. Wash out the rolling brush.



4. Clean the water-spraying channel and suction nozzle with the cleaning brush.



5. Clean the water-spraying channel and suction nozzle with wet rag.



6. Put the rolling brush back.

- If there is water leakage or no water out of the rolling brush, please check the water-spraying channel and the suction nozzle then clean the waste and dirty marks.
- It is recommended to replace a new rolling brush once every 2~3 months.

FAQ

Problem	Cause	Solution
Power bar flashing.	Motor worked abnormally.	Restart the device after clean the blockage in tubes of the dirty water bucket.
The device not working.	No power or low device battery.	Please fully charge the device before using.
	Rolling brush is wounded by the objects like hair.	Clean the rolling brush.
The suction power weakening.	Dirty water in the dirty water bucket has reached to designated capacity.	Take out of the dirty water bucket and dump the dirty water for reuse.
	Rolling brush and the dirty water bucket installing error.	Reinstallation.
	Rolling brush is wounded by the objects like hair.	Clean the rolling brush.
	Suction nozzle blocked.	Clean the foreign matters in the suction nozzle.
	Filter on the top of the dirt separator blocked.	Clean the filter before using.
	Low device battery.	Please fully charge the device before use.
	The HEPA is dirty.	Clean the HEPA and dry it thoroughly before use.
Abnormal sound for motor.	Suction nozzle blocked.	Clean the foreign matters in the suction nozzle.
	Dirty water in the dirty water bucket has reached to designated capacity.	Take out of the dirty water bucket and dump the dirty water for reuse.
	The HEPA is dirty.	Clean the HEPA and dry it thoroughly before use.
Failed to be charged.	The main device body and the charger interface are not well connected.	Please check and connect it well.
No water out of the rolling brush.	Clean water bucket has no water.	Add water to clean water bucket.
	Clean water bucket not installed properly.	Reinstall the clean water bucket.
Water leakage in air outlet.	HEPA not installed.	Install the HEPA properly.
	Dirt separator not installed.	Install the dirt separator.
	The HEPA not dry after being washing and using.	Before reuse, dry the HEPA thoroughly after washing and using it.
	Dirty water in the dirty water bucket has reached to designated capacity.	Take out of the dirty water bucket and dump the dirty water for reuse.

 For additional information about the device, please refer to www.ezviz.com/eu.